

Handle Bush

Spoon Handle Drill Bush

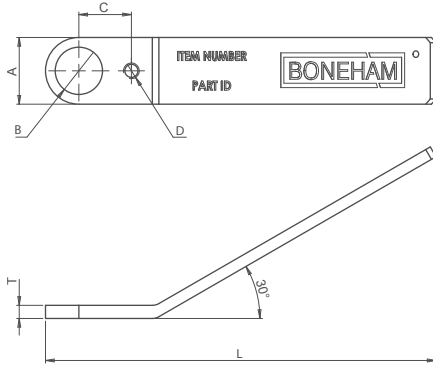

KEY FEATURES

- / Red Anodised Aluminium
- / Etched Part Code
- / Etched ID Range
- / Special Lock Screw Included

APPLICATION

Boneham Handle Bushes are designed to provide an accurate drilling tool without the need for a rigid fixture. Handle bushes are lightweight, ergonomic and able to provide precise drilling in hard to reach applications.

For applications in fixtures where multi drilling or reaming operations are required, liner bush can be placed in a complex fixture and each handle can be equipped with a pilot and multiple sizes of RD, RPS, SF and SFM bushes using standard renewable bushes and lock-screw

assembly. Handle bushes are a must have solution for controlled environments. Kits of bushes can be associated with one handle to reduce error and prevent loss.

Boneham Handle Bushes use renewable RD and RPS bushes to reduce tooling costs across a wide range of tooling, including conventional jigs, handles and egg cup style fixtures.

ORDERING INSTRUCTIONS

When ordering identify the OD size required based on the standard drill range.

Ordering example:

- / Handle Only: To Suit 10mm OD bush would be HBM-10
- / With Drill Bush: To Suit 10mm OD bush with 6mm bore would be HBM-10 - RD10H 6mm



INCH

Part No.	B	A	L	T	BS/Din Bushes	ANSI Bush	Lock screw
HB-12-SL	3/16	5/8"	4.75"	0.1968"	-	SF-12	HBLS0
HB-12	3/16	1"	4.75"	0.1968"	-	SF-12	HBLS0
HB-20-SL	5/16	5/8"	4.75"	0.1968"	RPS1	SF-20	HBLS1
HB-20	5/16	1"	4.75"	0.1968"	RPS1	SF-20	HBLS1
HB-32	1/2	1"	4.75"	0.1968"	RPS2	SF-32	HBLS1
HB-48	3/4	1"	4.75"	0.1968"	RPS3	SF-48	HBLS1

METRIC

Part No.	B	A	L	T	BS/Din Bushes	ANSI Bush	Lock screw
HBM-8-SL	8mm	16mm	4.75"	5mm	RD8	SFM-8	HBMS5
HBM-8	8mm	25mm	4.75"	5mm	RD8	SFM-8	HBMS5
HBM-10-SL	10mm	16mm	4.75"	5mm	RD10	SFM-10	HBMS5
HBM-10	10mm	25mm	4.75"	5mm	RD10	SFM-10	HBMS5
HBM-12	12mm	25mm	4.75"	5mm	RD12	SFM-12	HBMS6
HBM-15	15mm	25mm	4.75"	5mm	RD15	SFM-15	HBMS6
HBM-18	18mm	25mm	4.75"	5mm	RD18	SFM-18	HBMS6