

Adjustable Clamping Lever Straight Handle Hex Socket Female

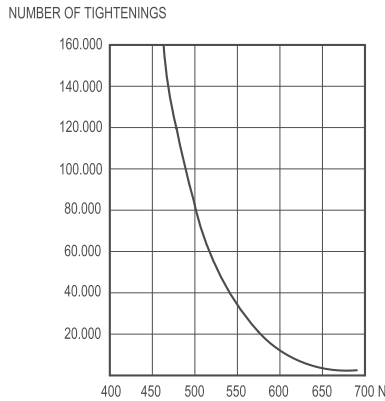

LEVER BODY

- / Glass-fibre reinforced polyamide based (PA) technopolymer. Resistant to solvents, oils, greases and other chemical agents

COLOUR

- / Black, orange, grey, matte finish
- / For sufficient quantities RAL 6011 green

CLAMPING ELEMENT

- / Glass-fibre reinforced technopolymer, black colour, with knurling on the protruding part to make initial tightening easier

ASSEMBLY

- / Execution A: black-oxide steel boss, plain or tapped blind hole. Black-oxide steel retaining screw, AISI 302 stainless steel return spring
- / Execution B: brass boss, tapped blind hole. Brass retaining screw, AISI 302 stainless steel return spring

FEATURES AND APPLICATIONS

Particularly suitable when the lever turning angle is limited owing to lack of space. Adjustable handles can be quickly screwed during assembly by means of electric or pneumatic screwdrivers with controlled tightening torque system.

INSTRUCTIONS OF USE

For clamping, lift the lever to disengage the clamping device toothing and bring it back to start position. By releasing the lever, the return spring automatically engages the toothing. If the lever cannot make a 360° rotation, the clamping element can be easily screwed by means of the hexagon socket front head screw (after having disengaged the lever).

STRESS RESISTANCE

Adjustable handles are generally used for repetitive clamping operations sometimes with very high-frequency. Therefore, the stress resistance (i.e. the resistance to repeated tightening cycles) of the handle unit is particularly important and, especially, the strength of the toothed element which transmits the tightening force from the handle to the threaded element (boss or stud). In fact, the results of several laboratory tests, performed with a special instrument that simulates the most severe use conditions, have shown that e.g. the adjustable handle can withstand without yielding more than 100,000 tightening cycles, under the action of a force of 490 N (see graphic).



Adjustable Clamping Lever Straight Handle Hex Socket Female

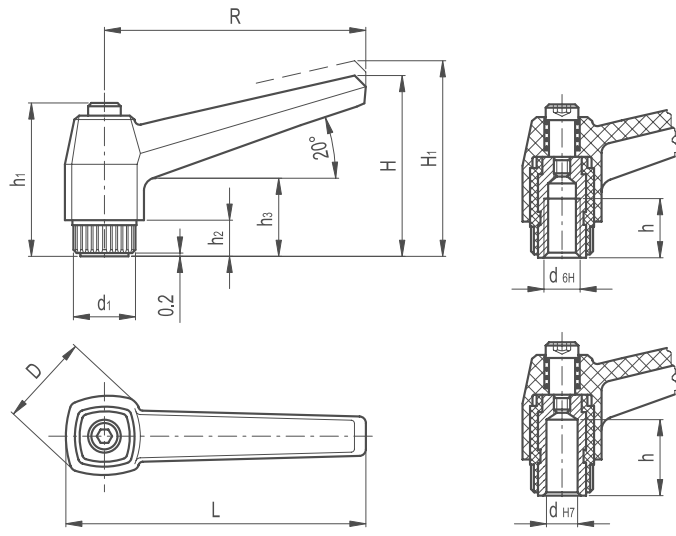

Part Reference - Black Orange Grey
Add 'O' Add 'G'

RAL 9005 RAL 2004 RAL 7031

Part Reference	R	L	D	H	H1	h1	h2	h3	d1	Mounting Hole			Teeth z	Bosses	
										d H7	d 6H	h		Steel	Brass
ACLHSF1	42	50	18	32	36.5	29	6	14	12	5	-	10	18	•	
ACLHSF2	42	50	18	32	36.5	29	6	14	12	-	M4	10	18	•	
ACLHSF3	42	50	18	32	36.5	29	6	14	12	-	M5	10	18	•	
ACLHSF4	42	50	18	32	36.5	29	6	14	12	-	M6	10	18	•	
ACLHSF5	42	50	18	32	36.5	29	6	14	12	-	M6	10	18		•
ACLHSF6	63	73	23	43	47	36	8	17	15	6	-	15	20	•	
ACLHSF7	63	73	23	43	47	36	8	17	15	-	M6	12	20	•	
ACLHSF8	63	73	23	43	47	36	8	17	15	-	M8	12	20	•	
ACLHSF9	63	73	23	43	47	36	8	17	15	-	M8	12	20		•
ACLHSF10	80	92	28	54	59.5	45	10	22	19	8	-	20	24	•	
ACLHSF11	80	92	28	54	59.5	45	10	22	19	-	M8	17	24	•	
ACLHSF12	80	92	28	54	59.5	45	10	22	19	-	M10	17	24	•	
ACLHSF13	80	92	28	54	59.5	45	10	22	19	-	M12	17	24	•	
ACLHSF14	80	92	28	54	59.5	45	10	22	19	-	M10	17	24		•
ACLHSF15	100	114	33	65	70.5	53	12	25	25	10	-	25	28	•	
ACLHSF16	100	114	33	65	70.5	53	12	25	25	-	M10	20	28	•	
ACLHSF17	100	114	33	65	70.5	53	12	25	25	-	M12	20	28	•	
ACLHSF18	100	114	33	65	70.5	53	12	25	25	-	M14	20	28	•	
ACLHSF19	100	114	33	65	70.5	53	12	25	25	-	M16	20	28	•	