

Adjustable Clamping Levers

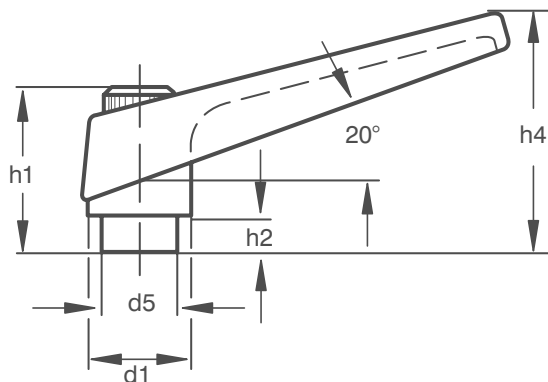

MATERIAL

/ Free Cutting Steel, blackened
/ Handle, zinc die casting, plastic coated

FEATURES AND APPLICATIONS

By pressing down the lever, the serrations are disengaged and the handle can then be swung to any desired position.



Female Ref	d1	d2	d4	l1	d5	h1	h2	h3	h4	l2	t	MALE REF
ACL7440-1	14	M5	M5	12	11.0	23	5.0	2.0	32	45	9	ACL7442-1
ACL7440-1	14	M5	M5	16	11.0	23	5.0	2.0	32	45	9	ACL7442-2
ACL7440-1	14	M5	M5	20	11.0	23	5.0	2.0	32	45	9	ACL7442-3
ACL7440-1	14	M5	M5	25	11.0	23	5.0	2.0	32	45	9	ACL7442-4
ACL7440-1	14	M5	M5	32	11.0	23	5.0	2.0	32	45	9	ACL7442-5
ACL7440-1	14	M5	M5	40	11.0	23	5.0	2.0	32	45	9	ACL7442-6
ACL7440-2	14	M6	M6	12	11.0	23	5.0	2.0	32	45	9	ACL7442-7
ACL7440-2	14	M6	M6	16	11.0	23	5.0	2.0	32	45	9	ACL7442-8
ACL7440-2	14	M6	M6	20	11.0	23	5.0	2.0	32	45	9	ACL7442-9
ACL7440-2	14	M6	M6	25	11.0	23	5.0	2.0	32	45	9	ACL7442-10
ACL7440-2	14	M6	M6	32	11.0	23	5.0	2.0	32	45	9	ACL7442-11
ACL7440-2	14	M6	M6	40	11.0	23	5.0	2.0	32	45	9	ACL7442-12
ACL7440-2	14	M6	M6	50	11.0	23	5.0	2.0	32	45	9	ACL7442-13
ACL7440-3	18	M6	M6	16	13.5	27	6.0	3.0	40	62	12	ACL7442-14
ACL7440-3	18	M6	M6	20	13.5	27	6.0	3.0	40	62	12	ACL7442-15
ACL7440-3	18	M6	M6	25	13.5	27	6.0	3.0	40	62	12	ACL7442-16
ACL7440-3	18	M6	M6	32	13.5	27	6.0	3.0	40	62	12	ACL7442-17
ACL7440-3	18	M6	M6	40	13.5	27	6.0	3.0	40	62	12	ACL7442-18
ACL7440-3	18	M6	M6	50	13.5	27	6.0	3.0	40	62	12	ACL7442-19
ACL7440-3	18	M6	M6	63	13.5	27	6.0	3.0	40	62	12	ACL7442-20
ACL7440-4	18	M8	M8	16	13.5	27	6.0	3.0	40	62	12	ACL7442-21
ACL7440-4	18	M8	M8	20	13.5	27	6.0	3.0	40	62	12	ACL7442-22
ACL7440-4	18	M8	M8	25	13.5	27	6.0	3.0	40	62	12	ACL7442-23
ACL7440-4	18	M8	M8	32	13.5	27	6.0	3.0	40	62	12	ACL7442-24
ACL7440-4	18	M8	M8	40	13.5	27	6.0	3.0	40	62	12	ACL7442-25
ACL7440-4	18	M8	M8	50	13.5	27	6.0	3.0	40	62	12	ACL7442-26
ACL7440-4	18	M8	M8	63	13.5	27	6.0	3.0	40	62	12	ACL7442-27

Adjustable Clamping Levers

30-33 serrations

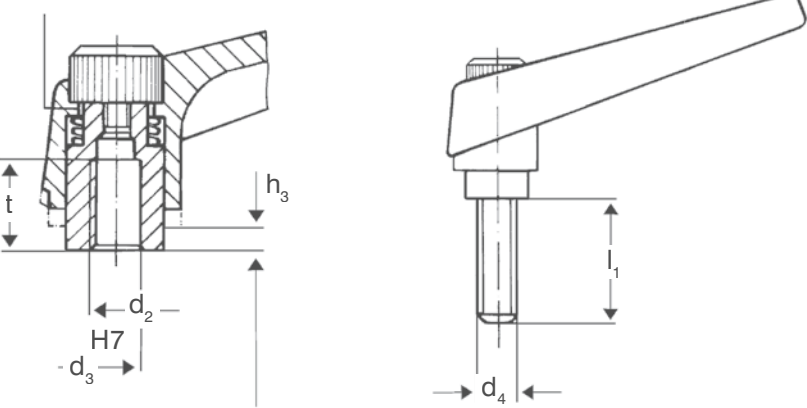

MATERIAL

- / Free Cutting Steel, blackened
- / Handle, zinc die casting, plastic coated

FEATURES AND APPLICATIONS

By pressing down the lever, the serrations are disengaged and the handle can then be swung to any desired position.



FEMALE REF	d1	d2	d4	l1	d5	h1	h2	h3	h4	l2	≥ t	MALE REF
ACL7440-5	22	M10	M10	20	16.0	33	7.0	4.0	50	74	15	ACL7442-28
ACL7440-5	22	M10	M10	25	16.0	33	7.0	4.0	50	74	15	ACL7442-29
ACL7440-5	22	M10	M10	32	16.0	33	7.0	4.0	50	74	15	ACL7442-30
ACL7440-5	22	M10	M10	40	16.0	33	7.0	4.0	50	74	15	ACL7442-31
ACL7440-5	22	M10	M10	50	16.0	33	7.0	4.0	50	74	15	ACL7442-32
ACL7440-5	22	M10	M10	63	16.0	33	7.0	4.0	50	74	15	ACL7442-33
ACL7440-5	22	M10	M10	80	16.0	33	7.0	4.0	50	74	15	ACL7442-34
ACL7440-6	25	M12	M12	25	19.0	38	9.5	5.5	58	89	18	ACL7442-35
ACL7440-6	25	M12	M12	32	19.0	38	9.5	5.5	58	89	18	ACL7442-36
ACL7440-6	25	M12	M12	40	19.0	38	9.5	5.5	58	89	18	ACL7442-37
ACL7440-6	25	M12	M12	50	19.0	38	9.5	5.5	58	89	18	ACL7442-38
ACL7440-6	25	M12	M12	63	19.0	38	9.5	5.5	58	89	18	ACL7442-39
ACL7440-6	25	M12	M12	80	19.0	38	9.5	5.5	58	89	18	ACL7442-40
ACL7440-7	30	M16	M16	32	23.0	45	10.5	6.0	70	108	24	ACL7442-41
ACL7440-7	30	M16	M16	40	23.0	45	10.5	6.0	70	108	24	ACL7442-42
ACL7440-7	30	M16	M16	50	23.0	45	10.5	6.0	70	108	24	ACL7442-43
ACL7440-7	30	M16	M16	63	23.0	45	10.5	6.0	70	108	24	ACL7442-44
ACL7440-7	30	M16	M16	80	23.0	45	10.5	6.0	70	108	24	ACL7442-45