

KOENIG EXPANDER® SEALING PLUGS

Series SK 550 / SKC 550



Material:
Sleeve: Case Hardening Steel, Gun Metal-Finish
Mandrel: Steel, Special Oil Film Lubrication

Important:
See installation instructions on page 80
Installation requirements on page 73

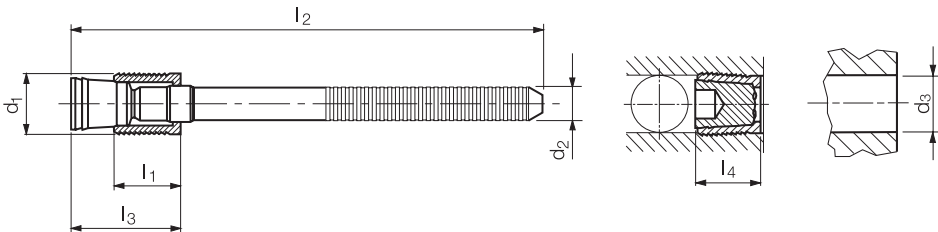

Part Number	d ₁	l ₁	d ₂	l ₂	l ₃ max.	l ₄ max.	d ₃ *	Packaging Unit**	Weight in gram/pcs.
SKC550 – 040	4.0	4.5	2.50	39	8.6	6.5	4.0	1000	1.71
SKC550 – 050	5.0	5.5	2.80	41	10.0	7.5	5.0	1000	2.50
SKC550 – 060	6.0	6.5	3.30	38	12.0	8.5	6.0	500	3.50
SKC550 – 070	7.0	7.5	4.00	38	13.5	9.5	7.0	500	5.10
SK550 – 080	8.0	8.5	4.20	40	14.9	10.5	8.0	500	6.33
SK550 – 090	9.0	9.5	4.50	43	17.1	11.5	9.0	250	8.23
SK550 – 100	10.0	10.5	4.80	43	19.1	13.5	10.0	250	10.57

Dimensions in millimeters
*Bore tolerance: See installation instructions on page 80
**Standard pack quantities may vary by sales organization

PRESSURE PERFORMANCE

Series SK / SKC 550 mm	①	②	③	⑤	⑥	⑦	⑧
	ETG – 100 / 44SMn28 AISI 1144	C15Pb / 1.0403 ~ SAE 1015 (10L15)	EN 1563: GJS – 600 – 3 ASTM A536: 80 – 60 – 03	EN 1561: GJL – 250 ASTM A48: NO.35	AlCu4Mg1 / EN AW – 2024 – T3 AA: 2024 T4/T6*	AlMgSiPb / EN AW – 6012 – T6 AA: 6012 – T6	G – AlSi7Mg / EN – AC – 42100 ASTM/UNS: A356
Base Material of the Installation							
Ø 4 – 10	1600 bar / 23200 psi 500 bar / 7200 psi					1400 bar / 20300 psi 450 bar / 6500 psi	

Proof Pressure Test – ⑧
Max. Allowable Working Pressure = Nominal Pressure
*SFC KOENIG's North American Engineering Department utilizes 2024 – T4/T6 as a test base material.