

KOENIG EXPANDER® SEALING PLUGS

Series LK 600

Material:

Sleeve: Stainless Steel, Special Oil Film Lubrication
Mandrel: Stainless Steel, Special Oil Film Lubrication

Important:

See installation instructions on page 81
Installation requirements on page 73

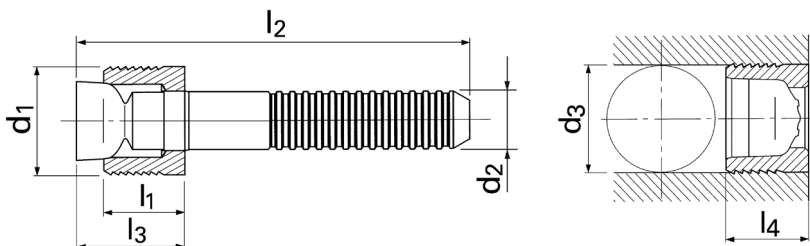

Part Number	d ₁	l ₁	d ₂	l ₂	d ₃ *	l ₃ max.	l ₄ max.	Packaging Unit**	Weight in gram/pcs.
LK 600 – 040	4.0	3.7	2.2	33	4.0	6.1	4.0	1000	1.19
LK 600 – 050	5.0	4.5	2.5	36	5.0	7.4	4.8	1000	1.81
LK 600 – 060	6.0	5.0	3.2	36	6.0	8.2	5.5	1000	2.95
LK 600 – 070	7.0	5.5	3.8	32	7.0	9.1	5.8	500	3.70
LK 600 – 080	8.0	6.5	4.3	34	8.0	10.8	7.0	500	5.26
LK 600 – 100	10.0	7.0	4.9	34	10.0	11.3	7.5	500	7.65

Dimensions in millimeters

*Bore tolerance: See installation instructions on page 81

**Standard pack quantities may vary by sales organization

PRESSURE PERFORMANCE

Series LK 600 mm	①	②	③	⑤	⑥	⑦	⑧
	ETG – 100 / 44SMn28 AISI 1144	C15Pb / 1.0403 ~ SAE 1015 (10L15)	EN 1563: GJS – 600 – 3 ASTM A536: 80 – 60 – 03	EN 1561: GJL – 250 ASTM A48: NO.35	AlCu4Mg1 / EN AW – 2024 – T3 AA: 2024 T4/T6*	AlMgSiPb / EN AW – 6012 – T6 AA: 6012 – T6	G – AlSi7Mg / EN – AC – 42100 ASTM/UNS: A356
Base Material of the Installation							
Ø 4 – 10	180 bar / 2600 psi 60 bar / 850 psi						

Proof Pressure Test – ⑧

Max. Allowable Working Pressure = Nominal Pressure

*SFC KOENIG's North American Engineering Department utilizes 2024 – T4/T6 as a test base material.