

Spherical Seat and Dished Washers Stainless Steel

Metric

153

CLAMPING & FIXING

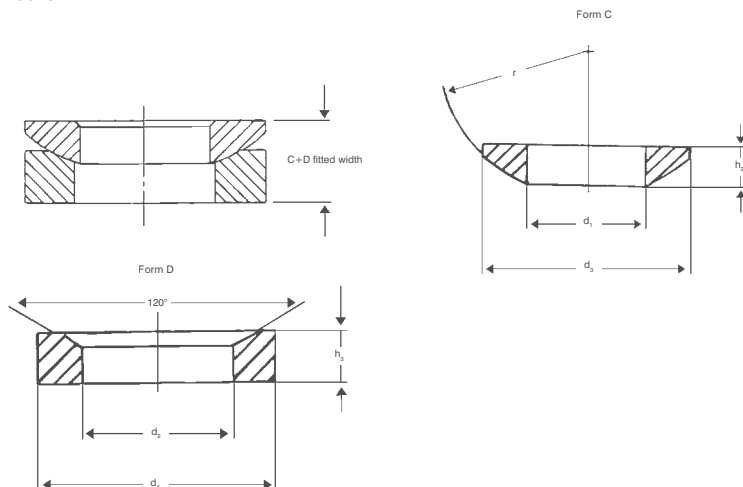

MATERIAL

/ AISI 303 stainless steel.

FEATURES AND APPLICATIONS

Concave and convex washers are suitable for locking mechanical parts on non-parallel surfaces. AISI 303 stainless steel, thanks to its high resistance to corrosion, allows the application of these washers on machines and equipment in those sectors where laws or particular hygienic, climatic and environmental factors make it mandatory to use corrosion resistant materials.

ORDERING INSTRUCTIONS

Spherical washers are sold singularly but can be requested in pairs. When ordering please use the below part codes followed with either:

/ C: Form C for the convex washer

/ D: Form D for the concave washer

Example: S1728-1950C

/ Dimensions are set out for both C & D under the same part code in the table below.



Part Reference	Screw	d1	d2	d3	d4	h2	h3	Total Width (c+d)	r
S1728-SS	M6	6.4	7.1	12	12	2.3	2.8	4.0	9
S1737-SS	M8	8.4	9.6	17	17	3.2	3.5	5.0	12
S1745-SS	M10	10.5	12.0	21	21	4.0	4.2	6.3	15
S1752-SS	M12	13.0	14.2	24	24	4.6	5.0	8.0	17
S1760-SS	M14	15.0	16.5	28	28	5.0	5.6	8.6	22
S1778-SS	M16	17.0	19.0	30	30	5.3	6.2	9.3	22
S1786-SS	M20	21.0	23.2	36	36	6.3	7.5	11.5	27
S1794-SS	M24	25.0	28.0	44	44	8.2	9.5	15.0	32
S1802-SS	M30	31.0	35.0	56	56	11.2	12.0	19.7	41
S1810-SS	M36	37.0	42.0	68	68	14.0	15.0	23.0	50
S1836-SS	M42	43.0	49.0	78	78	17.0	18.0	29.0	58
S1844-SS	M48	50.0	56.0	92	92	21.0	22.0	36.0	67